

## CABLE PULL- PRODUCT DATA SHEET

### FORGED STEEL, QUICK CONNECT, CABLE PULLING DEVICE

#### FEATURES AND BENEFITS

- The QuickFitting Cable Pull quickly and easily attaches to a cable, ready for pulling.
- Our patented push to connect technology provides a lower profile and easier pulling of cable through conduit, cable trays etc.
- Offers an alternative to crimp-on or wire mesh pulling devices - saving time and money.
- Available in many sizes with multiple lanyard lengths.
- Supplied as a ready to use item.
- No special tools required.



#### JUST PUSH TO CONNECT

##### 1 Mark it

Mark the insertion depth on the wire casing

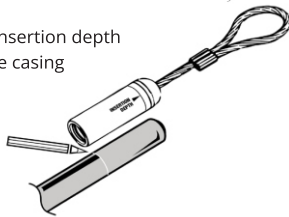

##### 2 Cut it

Cut the casing, remove the wire casing

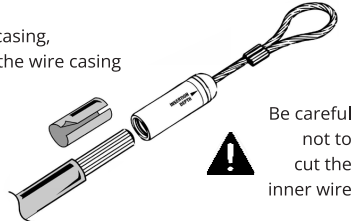

##### 3 Insert it

A/ Insert the wire into the cable pulling device

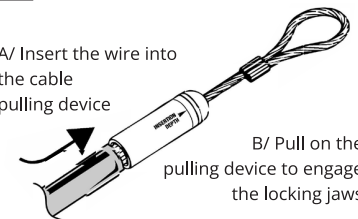

Part #	Conductor Area (mm <sup>2</sup> )	Lanyard Length (cm)	Copper WLL (kN)	Aluminum WLL (kN)
QFPD-30	95	15,30, 45, 60, 75	5	6
QFPD-250	120	15,30, 45, 60, 75	7	9
QFPD-300	150	15,30, 45, 60, 75	8	11
QFPD-350	185	15,30, 45, 60, 75	9	12
QFPD-500	240	15,30, 45, 60, 75	13	18
QFPD-600	300	15,30, 45, 60, 75	16	21
QFPD-750	400	15,30, 45, 60, 75	20	27
*QFPD-1000	500	20, 35, 55, 70, 85	27	36

\*Max outside diameter of conductor assumed to be of 27.81 mm.

The QuickFitting Cable Pull was designed, manufactured and tested for the below conductors to the referenced standards: Copper Unilay Compressed C and Copper Class B Compressed - ASTM B8-11 /2017. Aluminum Class B Compact - ASTM B800/2021 and ASTM B801/2018.

All measurements listed are approximate. The information is believed to be correct at the time of issue. Quick Fitting New Zealand Limited reserves the right to amend this specification without prior notice. Other sizes are available on request.

#### Contact us:

Quick Fitting New Zealand Limited.

P +64 9 390 7963 - E sales@quickfittingnz.com